

Pikesville High School Floor Plan 2016 - 2017

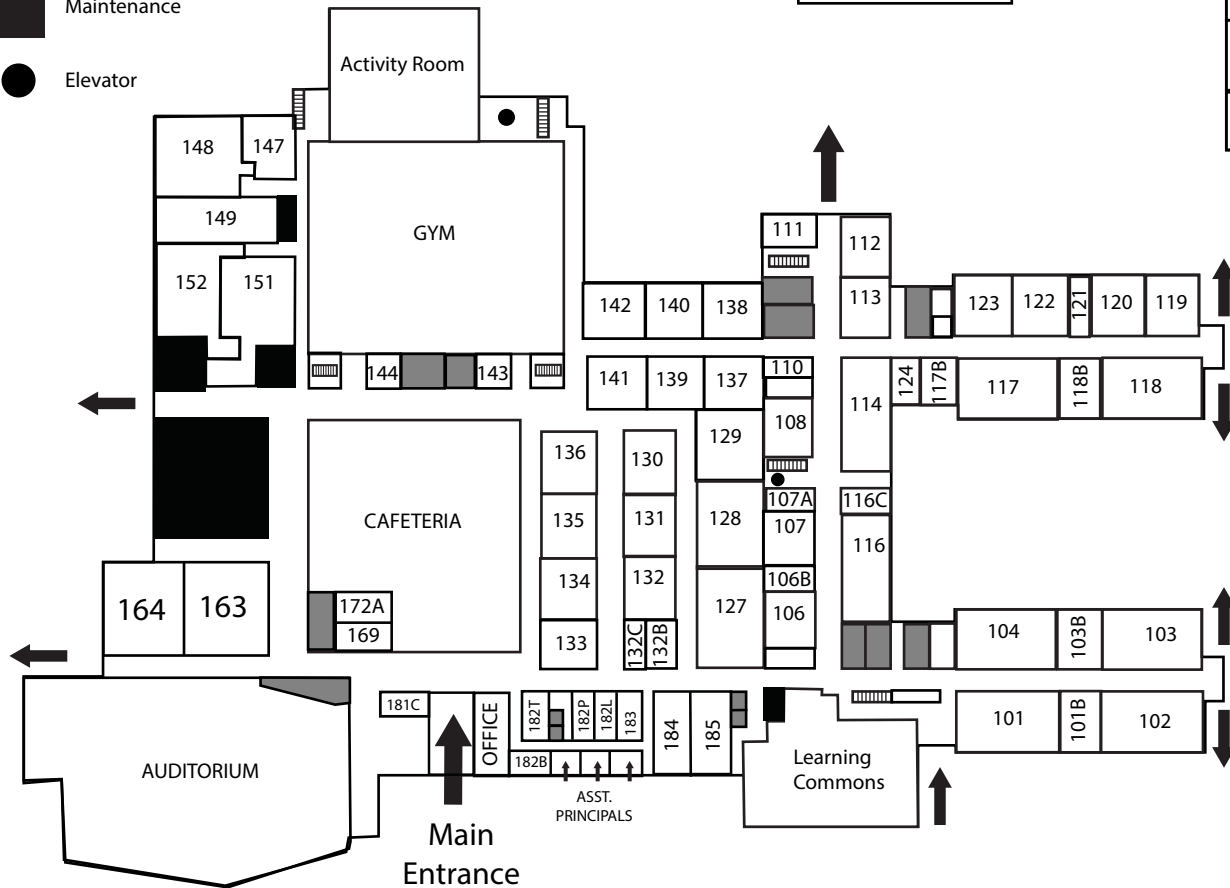

Lower Level

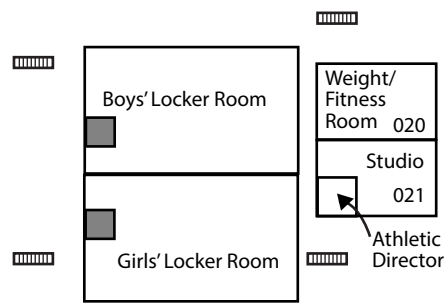

Second Floor

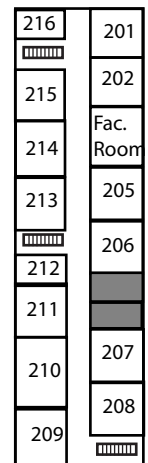

First Floor

- | | | |
|------------------------------|----------------------------------|--------------------------------------|
| 101 - Classroom | 128 - IMP Classroom | 144 - PE DC Office |
| 102 - Classroom | 129 - Business Classroom | 147 - Theater Arts |
| 103 - Classroom | 130 - Classroom | 148 - Art Classroom |
| 104 - Classroom | 131 - Classroom | 149 - Art Classroom |
| 106 - TV Studio | 132 - School to Career | 151 - STEM Classroom |
| 107 - IMP Studio | 132B - STC Office | 152 - STEM Classroom |
| 108 - Pipeline Lab | 132C - Social Worker | 163 - Vocal Music |
| 110 - Special Ed. Office | 133 - Executive Director's Suite | 164 - Instrumental Music |
| 111 - English Office | 134 - Music Lab | 169 - Testing |
| 112 - Classroom | 135 - Classroom | 172A - Faculty Dining |
| 113 - Classroom | 136 - Classroom | 181C - SRO Office |
| 117 - Classroom | 137 - Classroom | 182B - Bookkeeper |
| 118 - Classroom | 138 - Classroom | 182L - Principal's Office |
| 119 - Classroom | 139 - Classroom | 182P - Principal's Secretary |
| 120 - Classroom | 140 - Classroom | 182T - Teachers' Workroom |
| 121 - Math Office | 141 - Classroom | 183 - Administrative Conference Room |
| 122 - Classroom | 142 - Classroom | 184 - Faculty Lounge |
| 123 - Classroom | 143 - PE Office | 185 - Nurse's Suite |
| 124 - Dr. Fleischer's Office | | |
| 127 - School Counseling | | |

Second Floor

- | |
|-----------------------------|
| 201 - Classroom |
| 202 - Classroom |
| 205 - Classroom |
| 206 - Classroom |
| 207 - Classroom |
| 208 - Classroom |
| 209 - Classroom |
| 210 - Classroom |
| 211 - Classroom |
| 212 - Social Studies Office |
| 213 - Classroom |
| 214 - Classroom |
| 215 - Classroom |
| 216 - World Language Office |